

# ENHANCED COOLING KIT DXR 140/145

114 31 58-26  
Rev.B

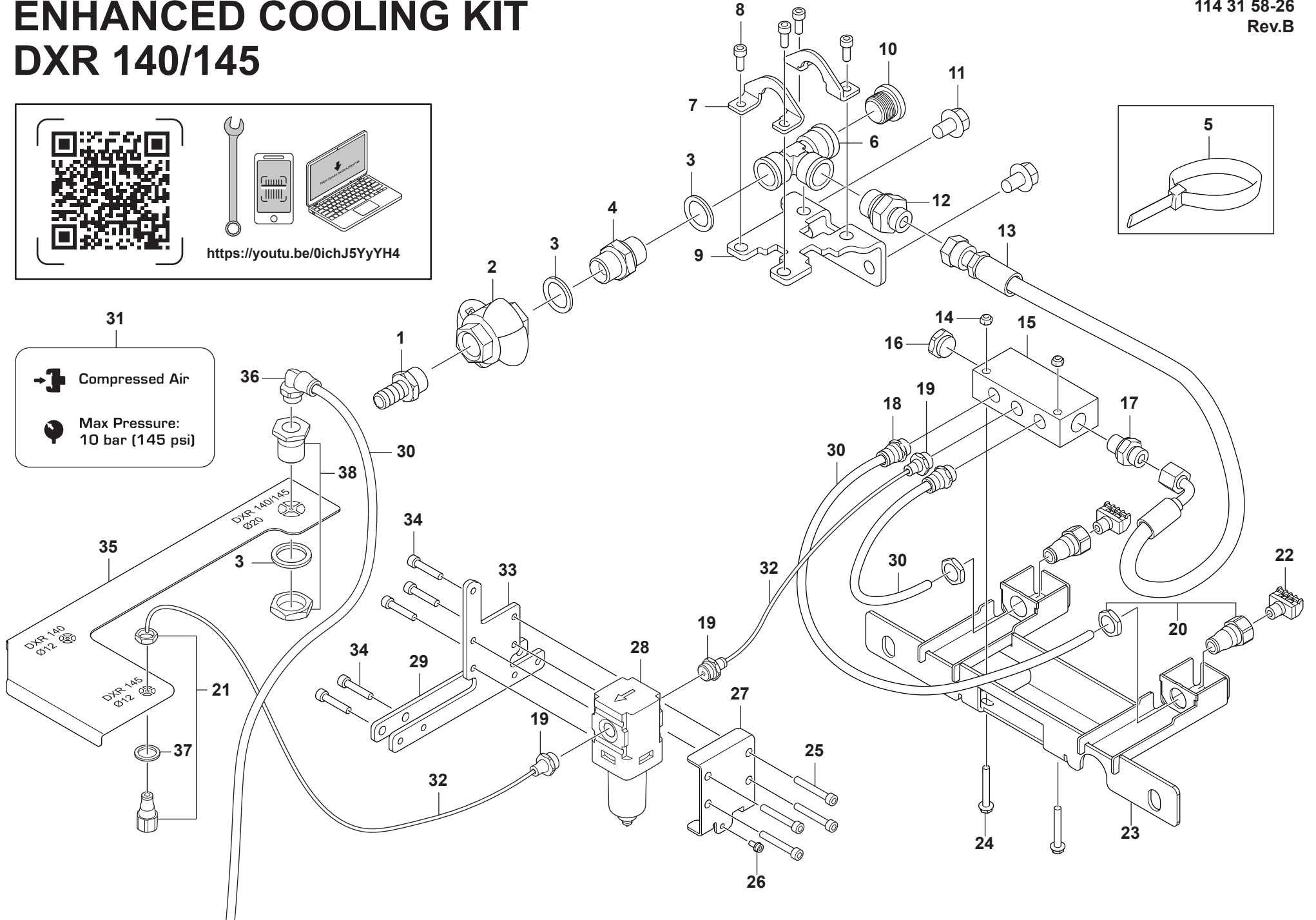

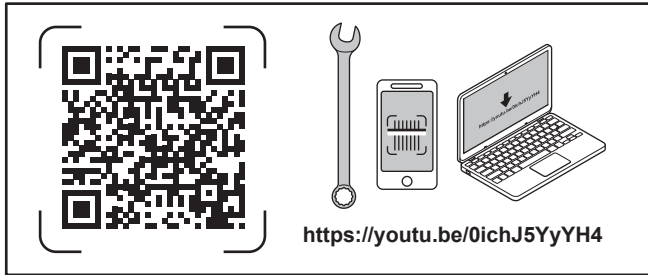

# ENHANCED COOLING KIT

## DXR 140/145

114 31 58-26  
Rev.B

Pos	Art no	Description	Comment	Qty
1	586 54 23-01	HOSE CONNECTOR	1/2" HOSE TO EXT G1/2"	1
2	586 47 20-01	COUPLING	CLAW COUPLING int G1/2"	2
3	501 72 09-03	WASHER	RUBBER-STEEL 1/2"	3
4	536 79 36-01	ADAPTER	STRAIGHT G1/2" - G1/2"	1
5	535 47 58-02	TIE WRAP		10
6	536 79 37-01	COUPLING	T 3x G1/2"	1
7	536 77 42-01	LATCH	AIR INLET	2
8	725 53 68-56	SCREW IHSCM	M6x16	4
9	536 77 39-01	BRACKET	AIR-INLET WELD ASSY	1
10	587 85 23-01	PLUG		1
11	585 99 73-01	SCREW EHHFM	M10x16	4
12	589 01 55-01	ADAPTER	STRAIGHT O: 11/16 - G: 1/2	1
13	536 81 80-01	HOSE ASSY	HOSE ASSY 11/16"- 1/4" - 9/16" 90°	1
14	732 21 14-01	LOCK NUT	M5	2
15	585 38 52-02	DISTRIBUTOR	2x3/8" 3x G1/4"	1
16	587 85 23-02	PLUG	PLUG VSTI-SHORT SOFTSEAL 3/8"	1
17	589 01 10-01	ADAPTER	STRAIGHT O: 9/16 - G: 3/8	1
18	586 20 57-01	HOSE CONNECTOR	PUSH-IN STRAIGHT	2
19	536 80 93-01	HOSE CONNECTOR	PUSH IN AIR STUD, G1/4 - Ø4	3
20	536 79 46-01	HOSE CONNECTOR	PUSH-IN BULKHEAD G1/8 - Ø8	2
21	536 79 47-01	HOSE CONNECTOR	PUSH-IN BULKHEAD G1/8 - Ø4	1
22	586 20 59-01	AIR NOZZLE	24x11mm, 1/8" 90	2
23	536 66 76-01	BRACKET	HEAT KIT NOZZLE & BLOCK HOLDER WELD ASSY	1
24	503 20 00-06	SCREW EHHFM	M5x35	2
25	725 53 80-06	SCREW IHSCM	M6x50	4
26	503 20 07-10	SCREW IHSCFM	M5x10	1
27	536 87 84-01	PLATE	AIR FILTER HOLDER	1
28	536 79 53-01	FILTER UNIT	AIR DXR 140/145	1
29	536 77 56-01	PLATE	AIR FILTER HEAT KIT	1
30	586 47 31-05	HOSE	PA 8mm, Length: 270mm	3
31	586 65 78-01	STICKER	AIR RECOMMENDATON DXR 140-315	1
32	536 81 56-01	HOSE	PA 4mm, cut to appropriate length	1
33	536 61 51-01	BRACKET	AIR FILTER, HEAT KIT	1
34	725 53 72-55	SCREW IHSCM	M6x25	5
35	536 82 84-01	INSTRUCTION	TEMPLATE ELECTRICAL CABINET	1
36	536 79 48-01	HOSE CONNECTOR	PUSH-IN 90° Ø8 -G1/4	1
37	501 72 09-01	WASHER	RUBBER-STEEL G1/4"	1
38	536 79 51-01	ADAPTER	BULKHEAD INT G1/4-G1/4 AIR	1